

# The Revitalisation of Builth Road

## A One Planet Development Approach



**PRESENTATION**

24 September 2012

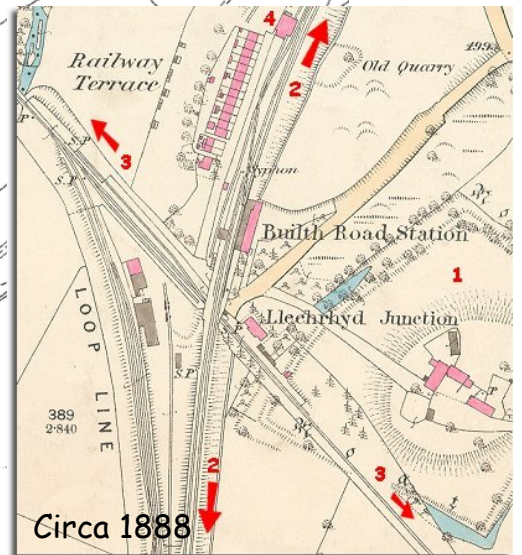
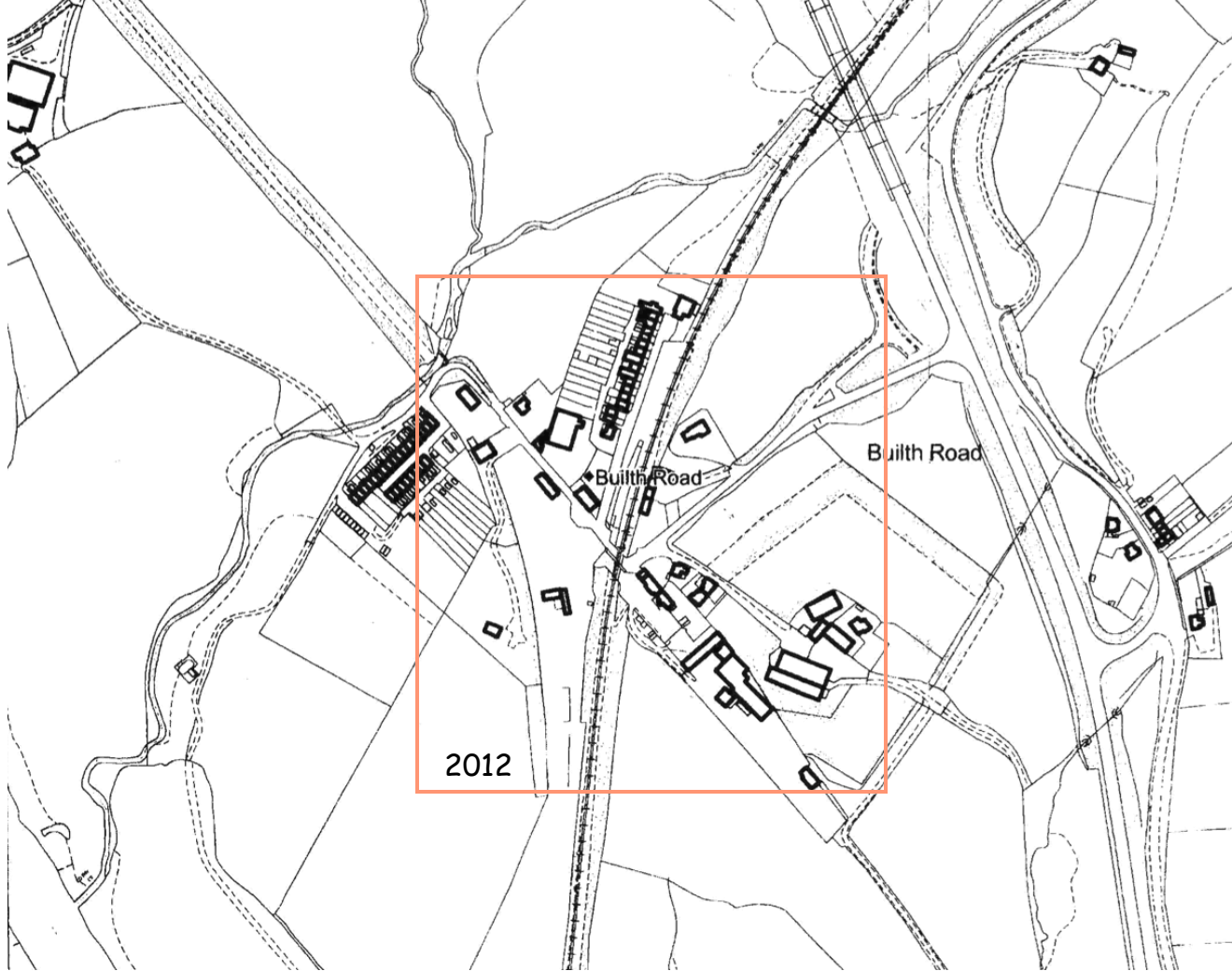





**Village approach from A470**





Ramp to station ( Private )





**Village entry - Heart of Wales Line crosses at high level**



Turn left into Cambrian Arms pub car park





The shop / Post Office on the corner



The Cambrian Arms - previously the low-level Station





The Lamp House



A row of old workshops beyond fence





**The workshops**



Looking back to railway crossing - Cambrian Arms pub on right





The former Mid-Wales line passed beneath left-hand span



Past the bridge, the “Brains” warehouse and yard to the right





...and to the left, the timber yard



The road turns left to pass under the former Mid-Wales line





**Wye View Terrace built by the Mid Wales Co for its workers 1885**





Typical C19th railway cottages. Wye View Terrace





Most of the cottages had vegetable gardens with chickens and pigs.





Headed back towards pub. Brains site on left, timber yard on right

THE  
CALON CYMRU  
NETWORK

A Community Interest Company

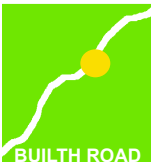





The timber yard frontage



Entry to timber yard on right, view through to pub car park





Turning to Railway Terrace on left



Railway Terrace, built in about 1890 for workers of the HoWL





Vacant land where the Station platform once was. Now used for open storage.



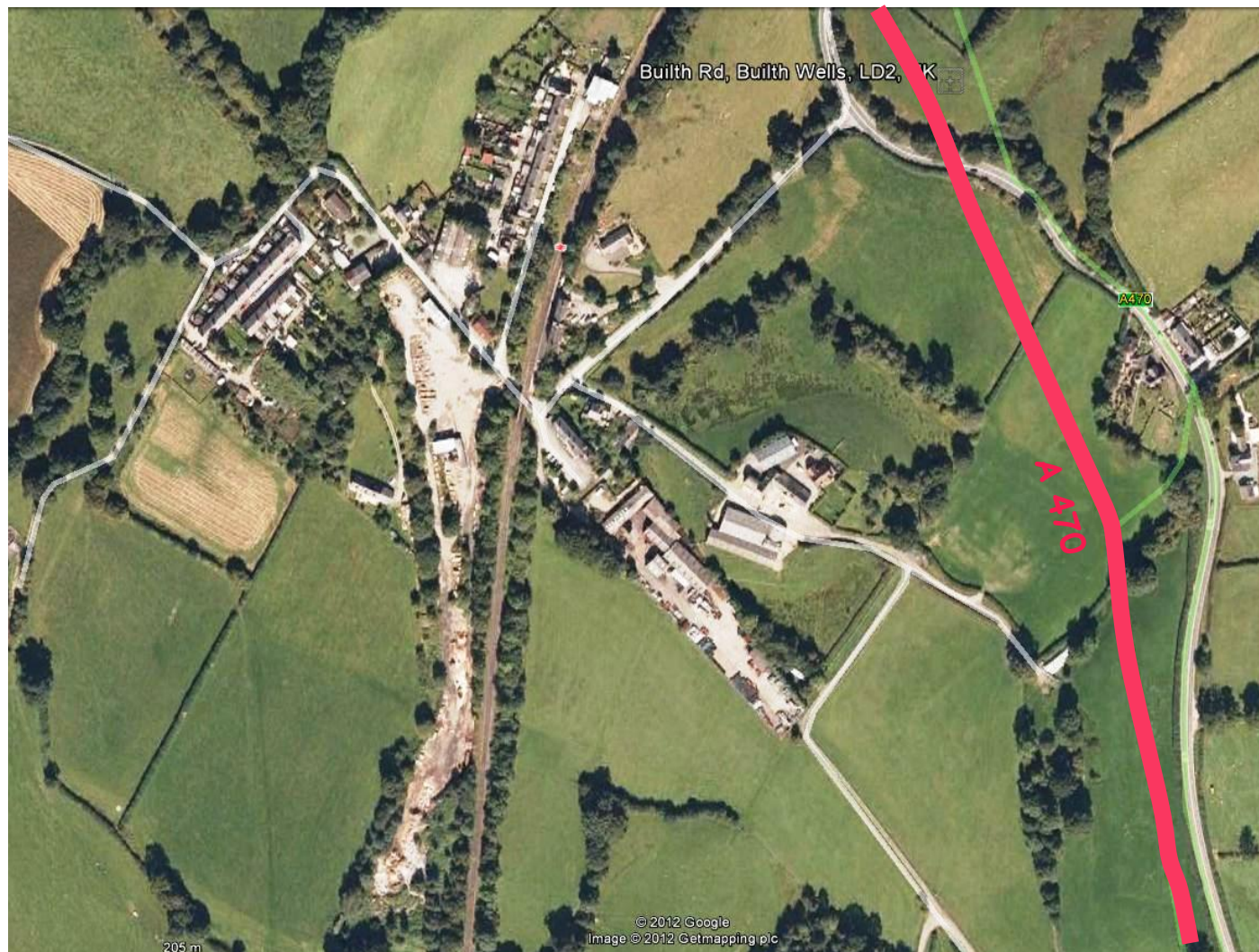

**BUILTH ROAD: Historic Railway Village**





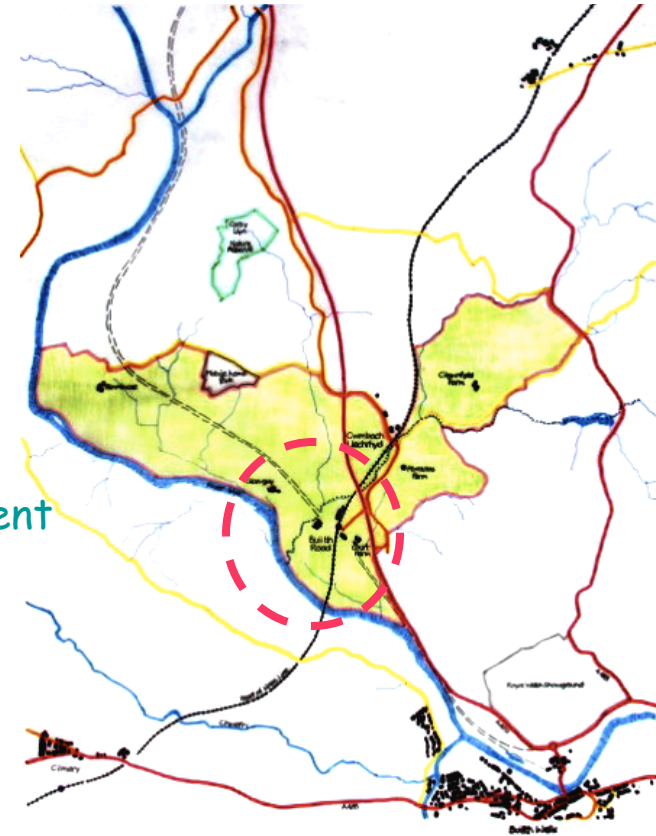
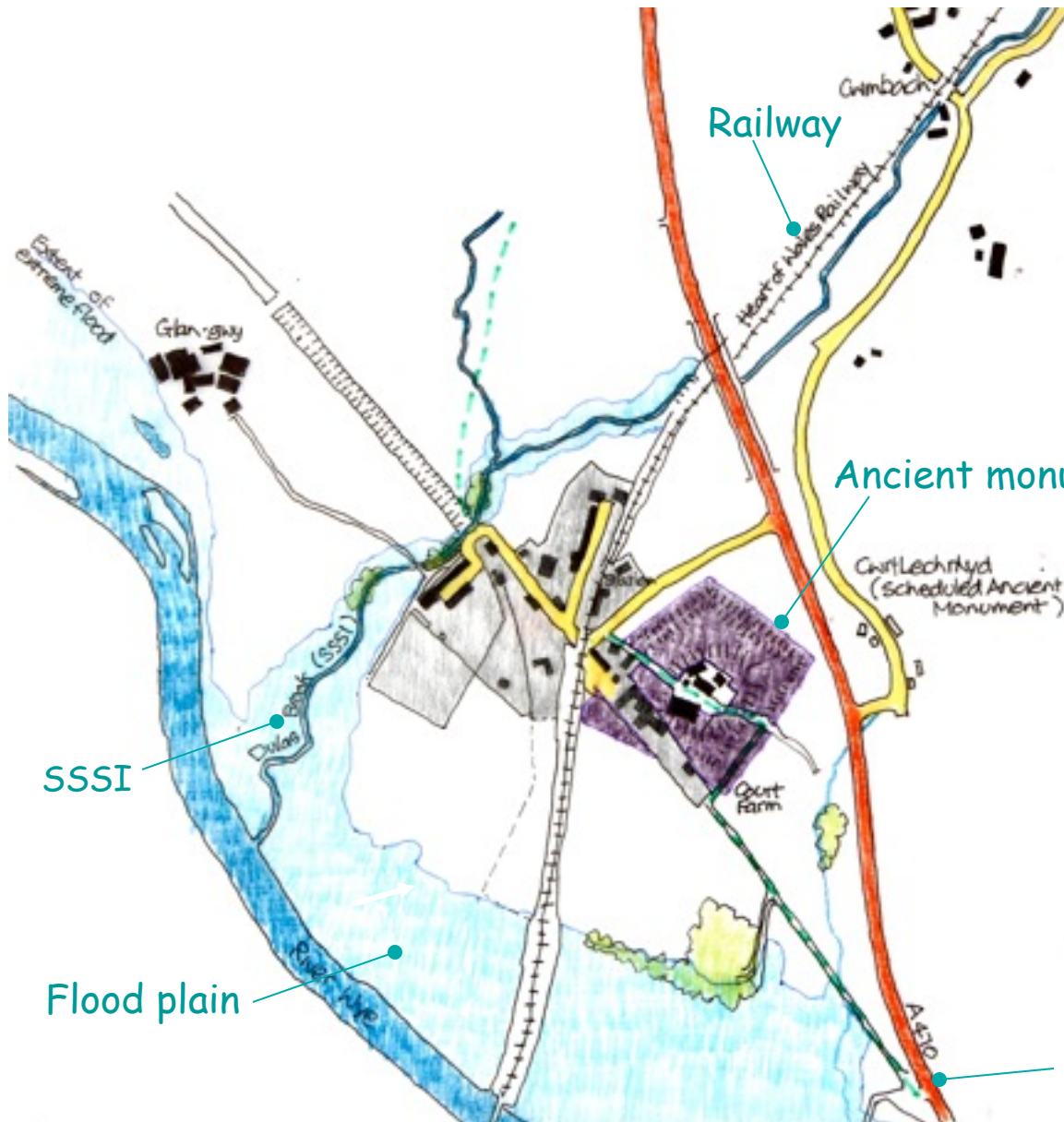

## A strategic location

- Railway line
- National N-S road corridor
- nearby Builth & Llandrindod Wells

New road

## Influences and constraints

**BUILTH ROAD 2012: Bypassed?**

THE  
CALON CYMRU  
NETWORK

A Community Interest Company



Community garden

Builth Road station

Playground and playing field

Industrial and storage sites  
Public footpath

Existing layout

Opportunities for new homes and workplaces

UDP settlement boundary  
Potential new homes & workplaces

NEW HOMES & WORKPLACES for YOUNG FAMILIES

THE  
CALON CYMRU  
NETWORK

A Community Interest Company

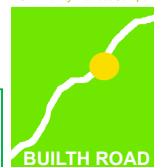



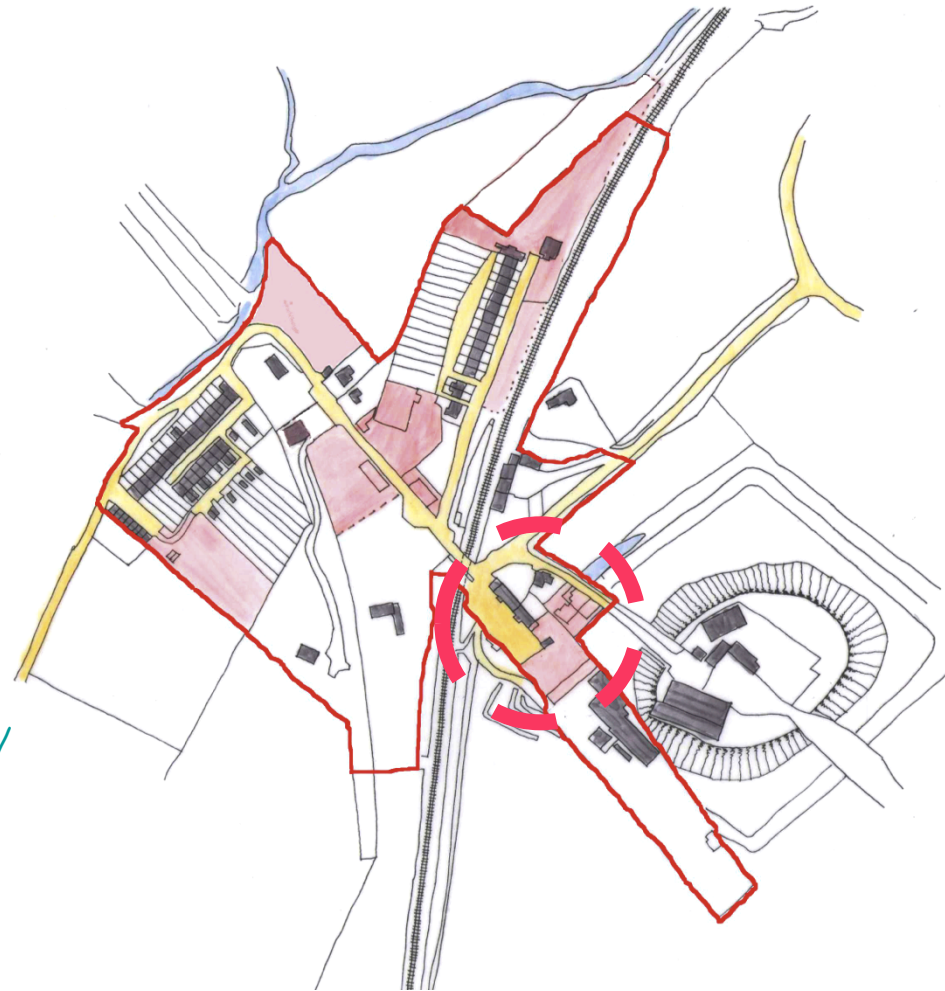

This sketch plan shows how vacant sites adjacent to the pub/shop could be developed to form a small group of cottages with vegetable gardens, flats and associated studios/workshops to provide affordable-rent accommodation for young households.

Other small-scale schemes could be carried out on vacant or underused land to build up the stock of flexible live/work homes in the village.

## The Cambrian Arms: A Village Square ?



**THE HEART of the VILLAGE**

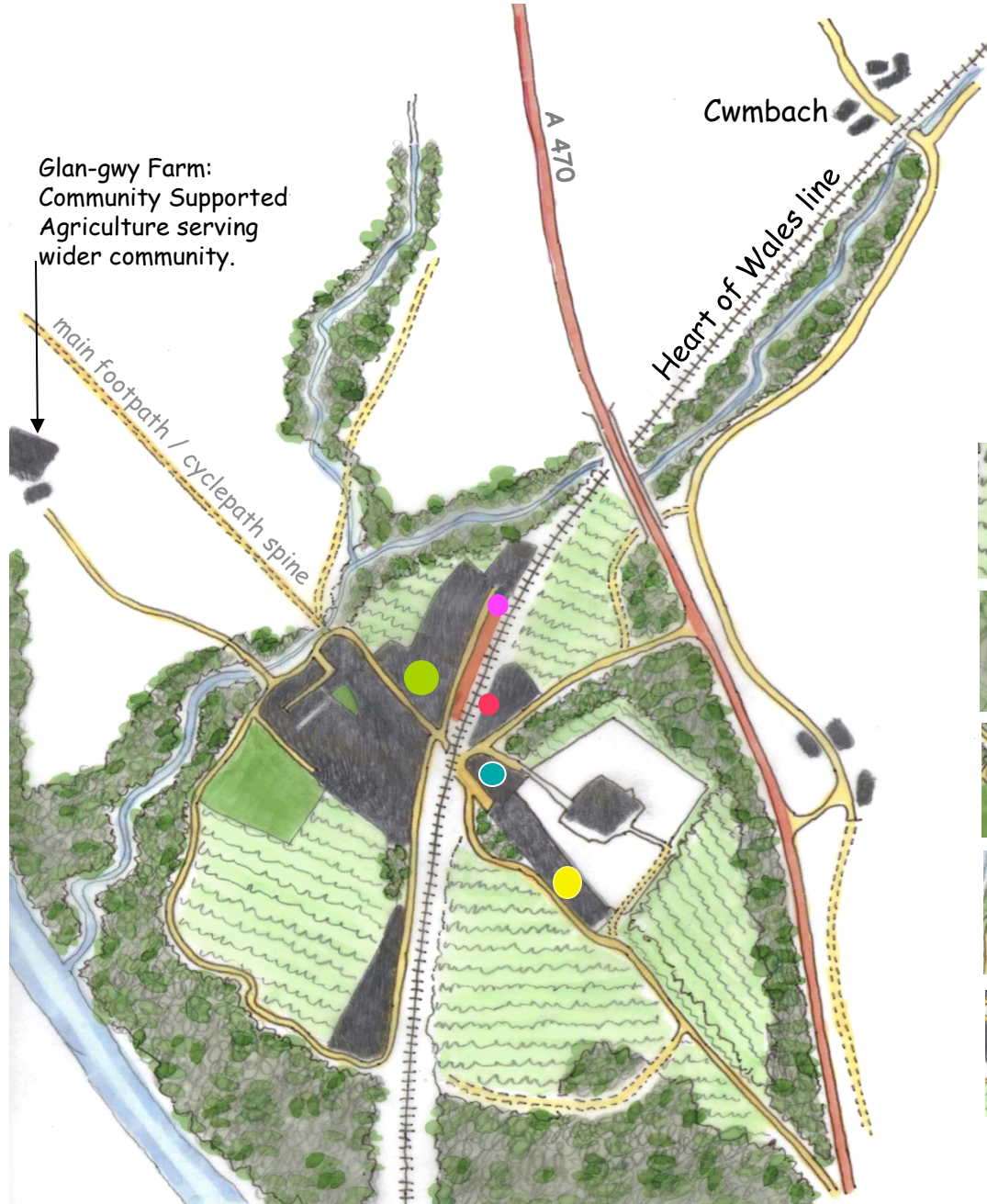

- Village square, pub and community shop / PO
- ● Village hall and offices. Car pool and village transport centre.
- Built Road station
- Rural workshops and village energy centre
- Village business hub.

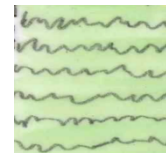

Allotments, orchards and small smallholdings. Food-growing by and for the village

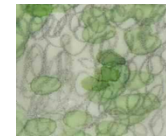

Mixed woodland: Fuel, building material and biodiversity



Built-up areas including private gardens



Village green spaces:  
Recreation ground, play area & community garden.



Cwrt Lechrhyd: Scheduled ancient monument

**A 2020 VISION for the VILLAGE of BUILT ROAD**

THE  
CALON CYMRU  
NETWORK

A Community Interest Company

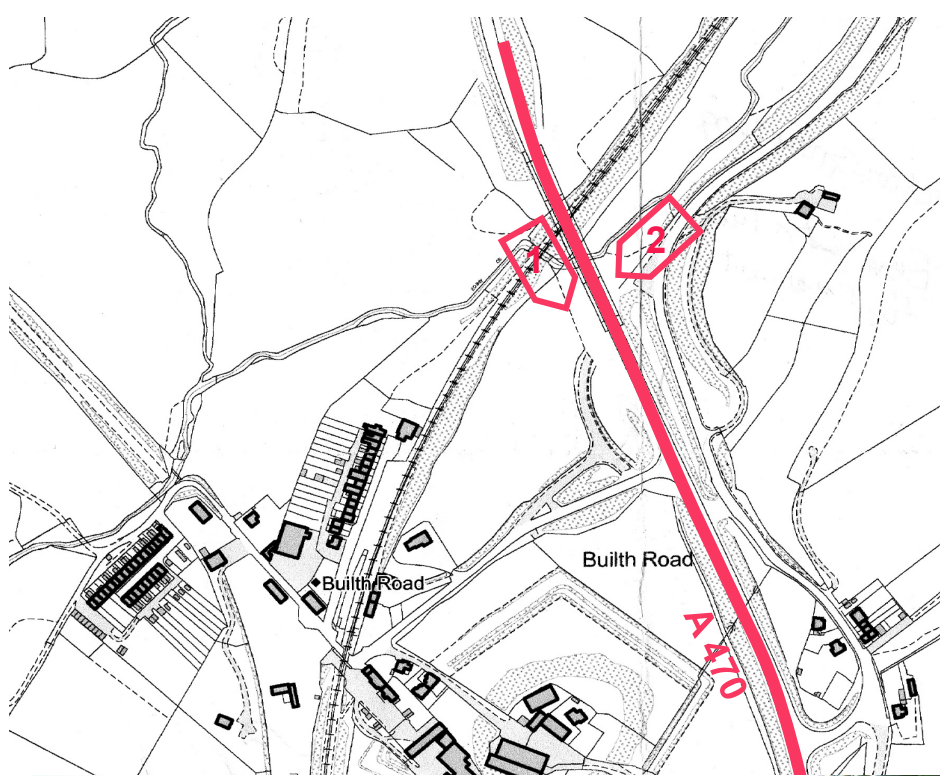











**Photo 1**

This shows a six year old child attempting to push his bike up the footpath under the new bridge on to the old road; this is as far as he got before his feet slipped out from underneath him and he fell over. He also slipped over coming back down the path without his bike on the way back. The picture quite effectively shows how steep the path is. The problem is compounded by the surface of the path, which is a single layer of gravel over compacted road planings and subsoil from the roadworks. This makes it almost as difficult as trying to navigate a scree slope.



**Photo 2**

This was taken from the top of the footpath by the old road looking down under the bridge. As you can see the path drops away very steeply and unnecessarily deep under the bridge (the man in the photo is 5' 8" tall).



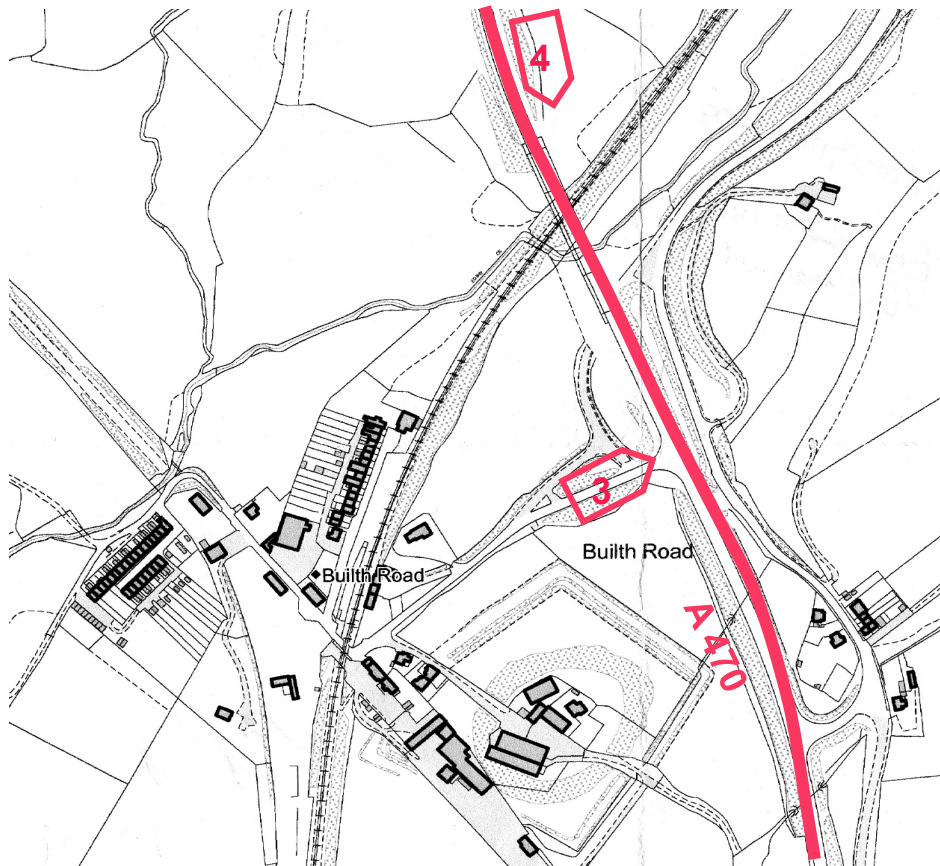

**Newbridge approach to Builth Road junction**



From the far end of the bridge.  
Can you see the road?

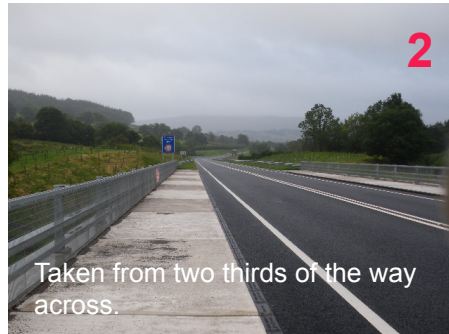

Taken from two thirds of the way  
across.



Taken from the end of the bridge

**Photos 4**

These were taken on the new bridge. It was a very grey and miserable day, which emphasises the problem very well! There is also an optical illusion caused when coming from Newbridge due to the size and position of the Cwmbach sign in the distance; it is a taller sign but due to the distance appears to be exactly the same size and height as the Builth Road sign, so they appear to be next to each other on opposite sides of the road. This is especially apparent in the dark.



**Photo 3**

This shows a view of the top of the road where it joins the A470, showing the gap in the bank next to/behind the sign pointing to Builth, and the lack of a gap in the barrier. It also shows where the children wait for the school bus (on the right hand corner of the entrance/exit road), and some lovely skid marks showing where someone did a handbrake turn. (NB. Due to issues with the bus primary school children on this route are currently going to school by taxi which comes down to the station/pub - once a larger bus has been found this will become an issue again)



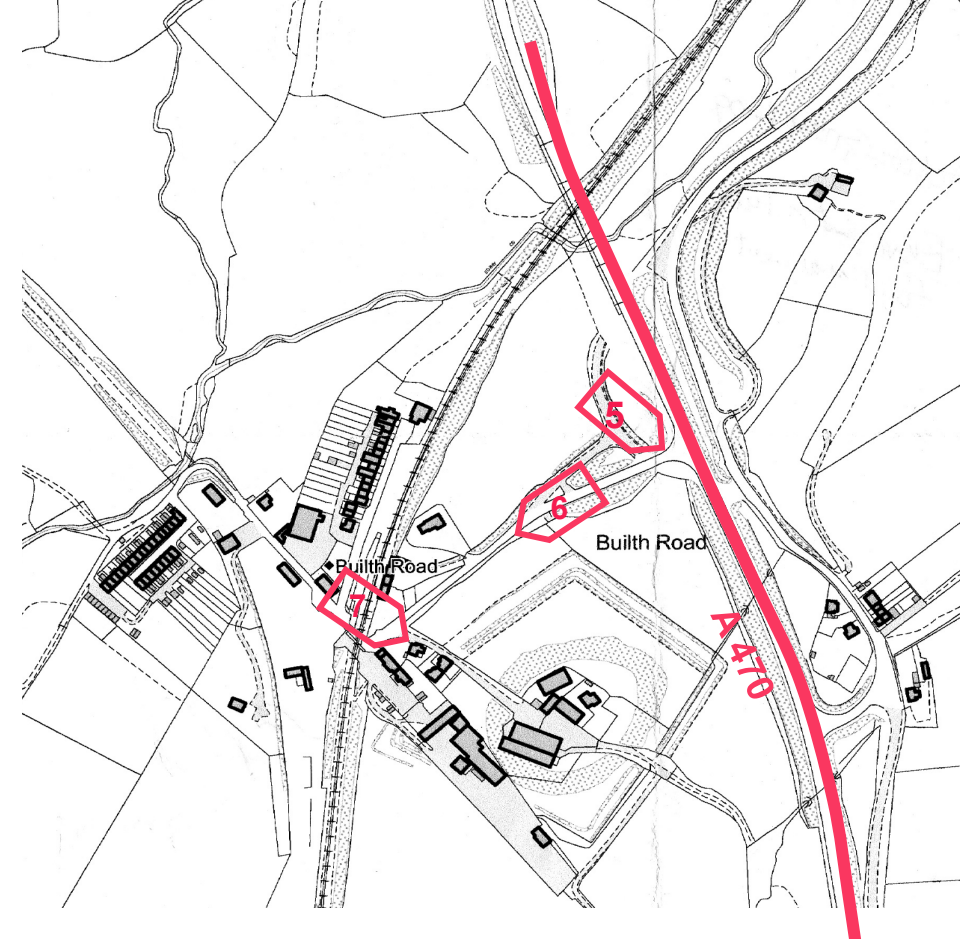

**Photo 5**  
**Potential bus stop** - This shows the triangle of grass that could be used as a turning/waiting place for the school bus.

It would also be very useful during show week when we have lots of double decker buses going to and from the station and struggling to turn round under the railway bridge. Alternatively it could be made into parking spaces for the station. It is where the new access road and the old access road join, so it is still tarmac underneath except for the corner where the grit bin is which used to be verge. When they grassed over the top they left the old road there, just drilled drainage holes in it, so although it would need resurfacing the foundations are still in place.

**Village entrance** - Having a 'Welcome to Builth Road' sign would make a big difference. Most of the residential properties aren't visible from the road, which is what makes the village seem like an industrial estate. Having a village sign would show that it is a village as well. It would also make a big difference to allow the village the dignity of a Welsh name as well, to enable it to stand as a separate entity to the Station, which is of course also called Builth Road.

**Footpath to Builth** - There is a public footpath to Builth that runs through Court Farm but is not signposted at all. The only sign on the turning says it is a private road.



**Photo 6**  
**Village entrance ?**  
**Welcome to Builth Road !**



**Photo 7**  
**Public footpath to Builth ?**





Approach from Builth - Cwmbach turn





Nearer the turning





























